

MV Island Pride

SCV - DP 2



Rev.date 13.06.19

ERN: 99,99,99,98
IMO nr: 9630547
DNV id no: 31949
MMSI: 257406000
Call Sign: LAGN8
Flag: Norway (NIS)
Port of registry: Aalesund

Type: Subsea Construction vessel
Design: UT 737 CD
Yard: Vard Brevik
Yard built no: 785
Delivery: 2014
Class: +1A1, ICE-C, Offshore Service Vessel
Supply, SPS, SF, COMF-V(3), HELDK, Eo,
DYNPOS-AUTR, NAUT-OSV(A), CLEAN
DESIGN, DK(+), HL(2,8)

PRINCIPAL DIMENSIONS

LOA: 103,30 m
Lpp. : 87,03 m
B mid.: 21,00 m
D main dk.: 8,80 m
Summer draft: 7,20 m
Deadweight: 4,600 t
Gross tonnage: 6,983 (GT)
Net tonnage: 2,097 (NT)

MAIN DUTIES

- AUV survey
- Multibeam seabed survey
- ROV survey
- Subsea construction
- Inspection, maintenance and repair (IMR)
- Module handling
- Crane work
- Supply duties

Technical specification

TANK CAPACITIES	
Water Ballast:	2196 m3
Fresh Water:	1052 m3
Fuel Oil incl. base oil tank:	1126 m3
Drill water:	2196 m3
Liquid mud:	1141 m3 (Dens. 2.8)
Brine:	494 m3 (Dens. 2.5)
Cement:	104 m3
Slop:	40 m3
All tanks can not be filled simultaneously	

CARGO PUMPS	
2 x Fuel oil pump	200m3/h - 9 bar (each)
2 x Fresh water pump	200m3/h - 9 bar (each)
2 x Ballast / Drill water pump	200m3/h - 9 bar (each)
2 x Mud pumps	100m3/h - 24 bar (each)
2 x Brine pump	100m3/h - 24 bar (each)
1 x Base oil pump	150m3/h - 9 bar
2 x Cement pumps	23m3/min (each)

CARGO DECK			
	Surface	Size	Max liad
Main deck	Wood	495 m2	10t/m2
AUV deck	Wood	145 m2	2t /m2
USV deck	Steel	135 m2	
Moon pool	Steel	70 m2	5t /m2

GENERATOR SETS	
Engines:	
2 x Bergen C25: 33L6ACD	1920 kW (each)
2 x Bergen C25: 33L9ACD	2880 kW (each)
Generators:	
2 x Main generators - 1843 kW	- 690 / 60 Hz
2 x Main generators - 2764 kW	- 690 / 60 Hz

PROPELLER PLANT	
2 x RRM Ulstein Aquamaster AZP 120 CP	2200 kW (each)

BOW THRUSTERS	
2 x RRM Kamewa Ulstein TT 2200 DPN CP	- 883 kW (each)
1 x RRM Ulstein Aquamaster TCNS 73/50	- 180 883 kW

DECK CRANES	
1 x Knuckle boom crane	SWL 5t - 8-12m
1 x Knuckle boom crane	SWL 20t - 10m
1 x National Oilwell	SWL 125t - 8m 30t - 30m (main) SWL 20t - 32m (aux) (Drum capacity 3000m)
1 x Telescopic	SWL 3t - 8-16 m

DYNAMIC POSITION SYSTEM	
Type:	Marine Technologies
Class Definition:	DYNPOS AUTR.
	ERN (99.99.99.98)

ROV	
2 x Fully, integrated WROV and LARS systems for launch simultaneously permanent installed onboard, capacity approx 5500 m	

AUV	
Dedicated AUV hangar for launch and recovery, stowage and maintenance	

HELICOPTER DECK	
- Helicopter deck forward.	
- Dia. 26.1 m for Sikorsky - S92	
- D-value 20,88m	
- T-value 12,8t	

MOON POOL	
Moon Pool size:	7200 x 7200 mm
Hatch max load:	5t/m2

SAFETY EQUIPMENT	
Life-saving appliances are provided for minimum 91 persons, and are installed in accordance to the Mobile Unit Safety Equipment Certificate.	

ACCOMMODATION / VESSEL FACILITIES	
The accommodation facilities provide for a total number of 91 persons:	
16 off single cabins (16 pax)	
33 off double cabins (66 pax)	
3 off three-man cabins (9 pax)	
4 off offices	
1 off large conference room	
1 off hospital	
1 off ROV control room	
1 off ROV work shop	
1 off mess room	
3 off dayrooms	
Gymnasium	
Sauna	
Heli reception/ cinema	

M/V Island Pride

Profile

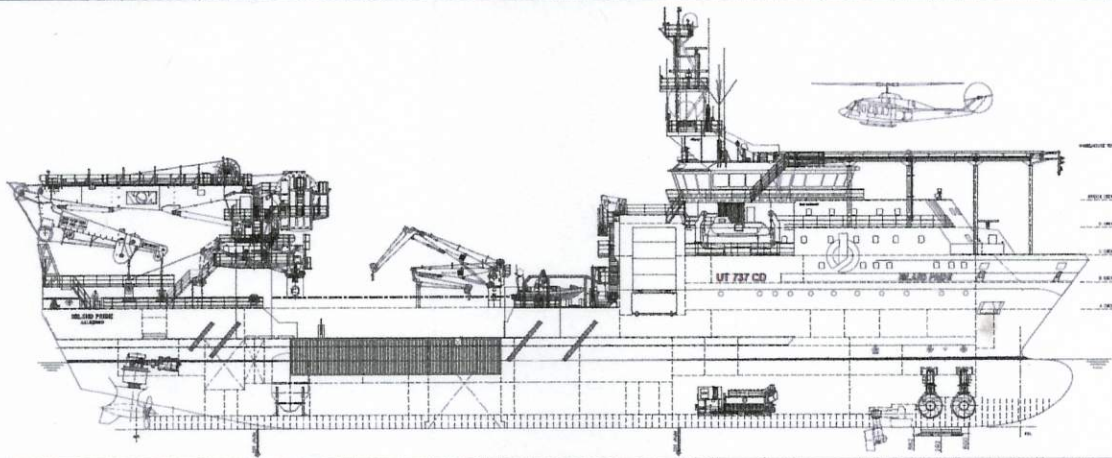

A - Deck

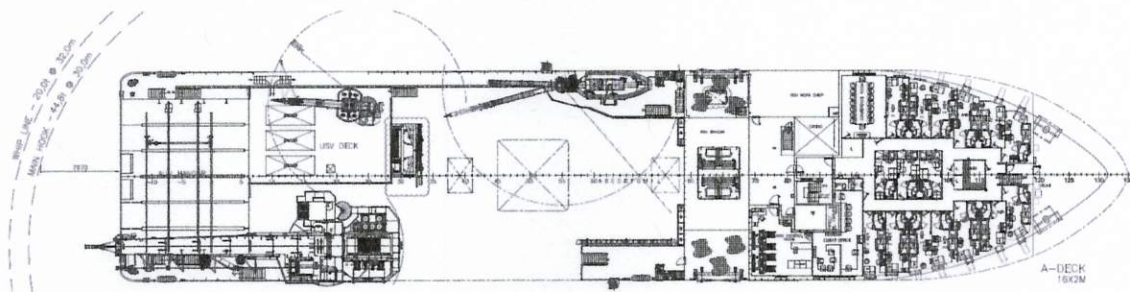

Main Deck

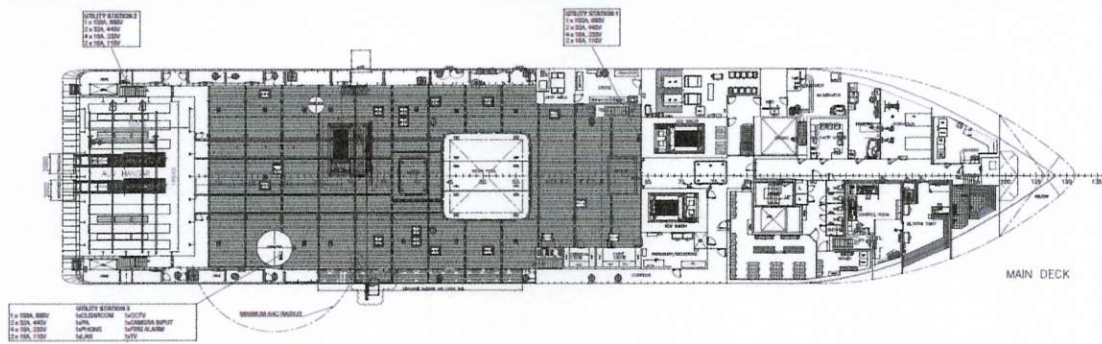

2nd Deck

